



Kahuna Design, United States

Key Facts

Company: Kahuna Design LLC

Website: www.kahunausa.com

Industry: Plant Design

Country: United States

Products Used:

- CADWorx®

Kahuna Design LLC Leverages CADWorx® to Grow Its Business

Headquartered in Colorado, Kahuna Design LLC specializes in engineering, design, construction and operations of natural gas treating and processing facilities. Founder Mark Bross already had multiple projects lined up when he founded the company in 2011, due in large part to his extensive experience in piping and plant design.

Designing a Large Cryogenic Gas Plant for Caiman Energy

One of Kahuna's first projects was for Caiman Energy Inc. of Dallas, Texas. Caiman had chosen them for the design and engineering for a 200-MMcfd (million cubic feet per day) cryogenic gas plant project at Fort Beeler in West Virginia. Ultimately expanded to include three plants producing over 700-MMcfd of gas, the project entailed around \$5 million worth of complex piping ranging from 2" to 24" diameter. Kahuna was to produce a complete 3D model of the piping system; create isometric drawings, sections and elevations for fabrication and facility construction; and produce complete project bills of material for purchasing.

Fitting Complex Piping into a Confined Area

The project posed a number of challenges. The small footprint for the facility meant that the piping had to be designed with accuracy to ensure a precise fit and avoid expensive on-site rework. The project also required just-in-time production scheduling, leaving no room for errors or delays. Another challenge included working with a third-party vendor that was providing drawings for the manufacture of the skids. The models and drawings Kahuna produced had to be in sync with these third-party drawings while also matching the client's specifications.

Benefiting From the Right Tools for the Job

Faced with this large and complex project, Kahuna Design had another major challenge common among many new companies – a lack of people for the job. Fortunately, the company had invested in CADWorx®. This industry-preferred software for intelligent 3D plant design provides high levels of automation making it popular with many top designers and engineers. Having the right tools helped Kahuna Design quickly attract the right people for the job, growing to 20 employees within a short period of time.

Producing Accurate Deliverables on Schedule

Because CADWorx is so easy to learn and use, even those with minimal training on the software became productive within a few days, establishing project specifications and addressing basic project management requirements. With the CADWorx models for client reviews, Kahuna was able to identify potential design errors early, saving significant time and expense. The intelligence and automation provided by CADWorx also improved accuracy, reduced work hours and improved productivity.

Establishing Credibility for Kahuna's Future Growth

With the right tools and people, it was able to address the client's needs and quickly establish credibility for the company. This success has already helped Kahuna bring in a number of new projects, achieving a steady workload in a very short period of time and a flourishing reputation, bring a successful return on its investments in the best tools and people.

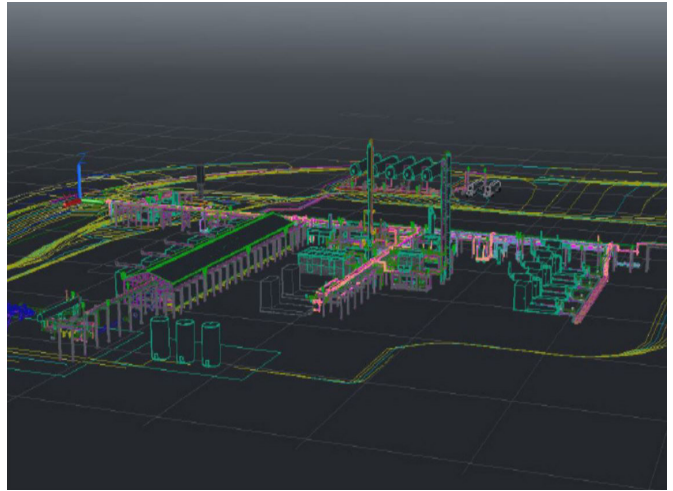

About Hexagon

Hexagon is a global leader in sensor, software and autonomous solutions. We are putting data to work to boost efficiency, productivity, and quality across industrial, manufacturing, infrastructure, safety, and mobility applications.

Hexagon's PPM division empowers its clients to transform unstructured information into a smart digital asset to visualize, build and manage structures and facilities of all complexities, ensuring safe and efficient operation throughout the entire lifecycle.

Hexagon (Nasdaq Stockholm: HEXA B) has approximately 20,000 employees in 50 countries and net sales of approximately 3.9bn EUR. Learn more at [hexagon.com](https://www.hexagon.com) and follow us @HexagonAB.